

New List Slicer Visuals

IN POWER BI

Swipe →

Introduction

Slicers in Power BI allow users to interact directly with the data. Slicers are especially useful for adjusting numeric values or dates, making it easy to select ranges that immediately update the related charts and tables. This gives end users the ability to explore different scenarios without having to modify queries or the report design.



Button Slicer



List Slicer

Activate October updates

- Let's go to Options and Settings.
- Then, go to Preview Features.
- Select List Slicer Visual and Button Slicer Visual.
- After that, it will prompt us to close and reopen Power BI Desktop.

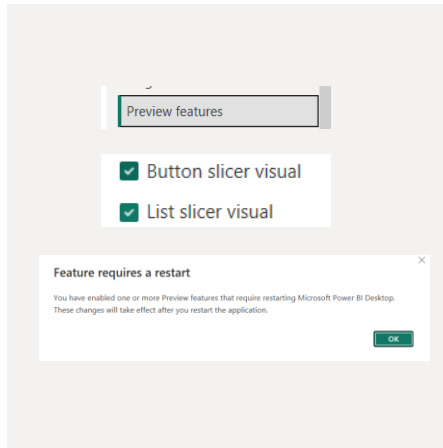

Lest's get to work!!!

Let's start with the new Button Slicer option.

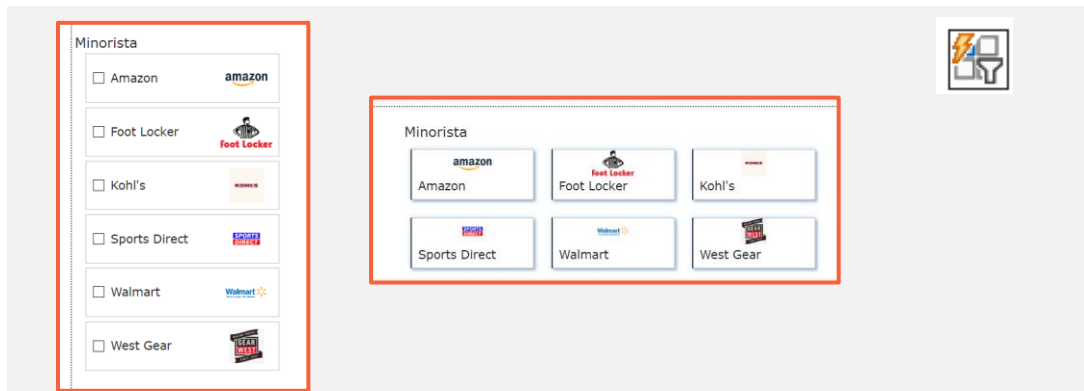

The image displays two views of the Minorista interface. On the left, a vertical list of retailers is shown, each with a checkbox and a logo: Amazon, Foot Locker, Kohl's, Sports Direct, Walmart, and West Gear. This list is enclosed in a red rectangular border. On the right, a 'Button Slicer' view is shown, also enclosed in a red rectangular border. It features a 2x3 grid of buttons, each containing a retailer's logo and name: Amazon, Foot Locker, Kohl's, Sports Direct, Walmart, and West Gear. In the top right corner of the interface, there is a small icon of a lightning bolt striking a button, representing the Button Slicer feature.

Let's get to work!!!

Let's continue with the List Slicer Visual options.

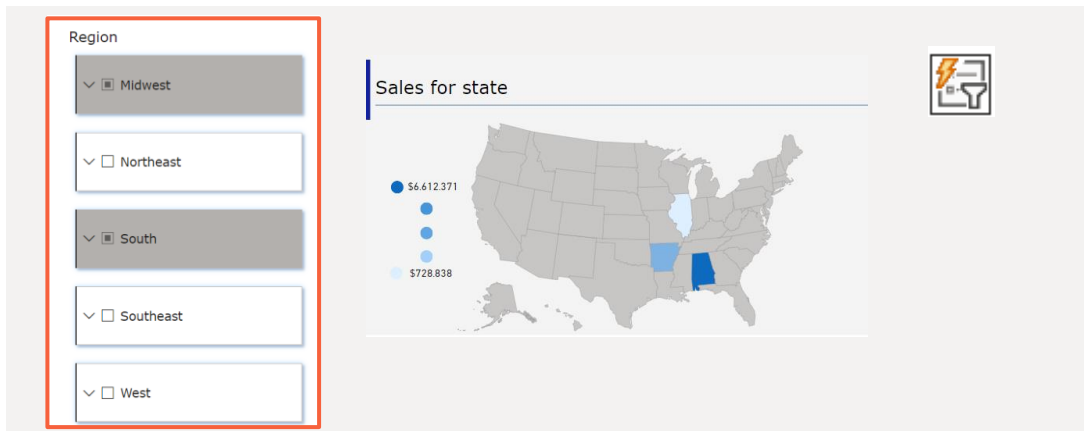

Advantages

1. List Slicer with Images (Retailer):

- Attractive visualization: Images next to the categories improve quick and visual identification.
- Intuitive navigation: Facilitates quick selection of options through a more graphical interface.

2. Dropdown List Slicer with Subcategories (Region):

- Clear organization: Groups related items, simplifying data exploration.
- Efficient use of space: Dropdown lists handle large datasets without overcrowding the screen.

CAN I HELP YOU?

**REMEMBER TO
SAVE THIS
ARTICLE**



WWW.FP20ANALYTICS.COM